

Plant List

KEY COMMON NAME	SCIENTIFIC NAME	QTY.
1 TAUNTON SPREADING YEW	TAXUS X MEDIA 'TAUNTON'	2
2 DIABOLO NINEBARK	PHYSOCARPUS OPULIFOLIUS 'MONLO'	1
3 BLUE MIST FOTHERGILLA	FOTHERGILLA GARDENIA 'BLUE MIST'	10
4 CORAL SUNSET PEONY	PAEONIA 'CORAL SUNSET'	9
5 RHEINGOLD ARBORVITAE	THUJA OCCIDENTALS 'RHEINGOLD'	6
6 BOWHALL MAPLE	ACER RUBRUM 'BOWHALL'	1
7 TECHNY ARBORVITAE	THUJA OCCIDENTALS 'TECHNY'	8
8 PAPERBARK MAPLE	ACER GRISEUM	1
9 CENTER GLOW NINEBARK	PHYSOCARPUS OPULIFOLIUS 'C. GLOW'	1
10 OAKLEAF HYDRANGEA	HYDRANGEA QUERCIFOLIA	7
11 TINKERBELLE LILAC	SYRINGA 'BAILBELLE'	3
12 SERVICEBERRY	AMELANCHIER X GRANDIFLORA	1
13 PERIWINKLE	VINCA MINOR	50





*Symmetry
and
Balance*

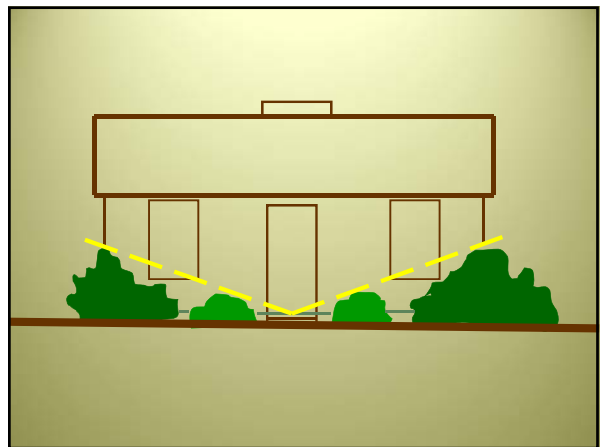
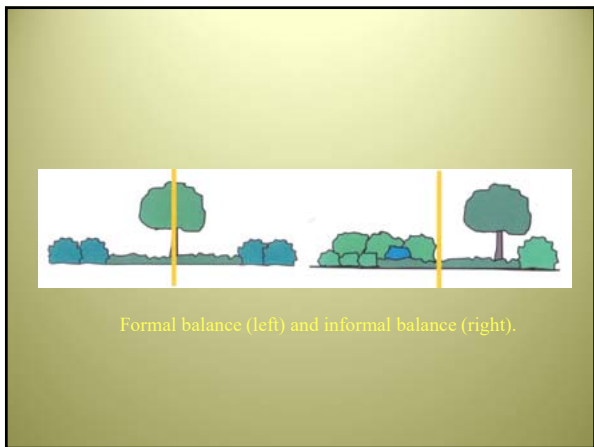

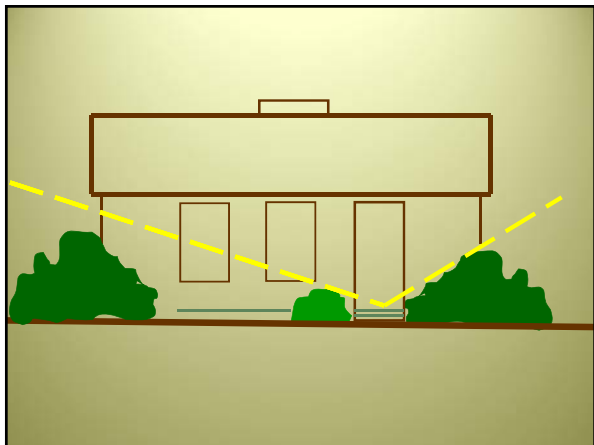

Simplicity







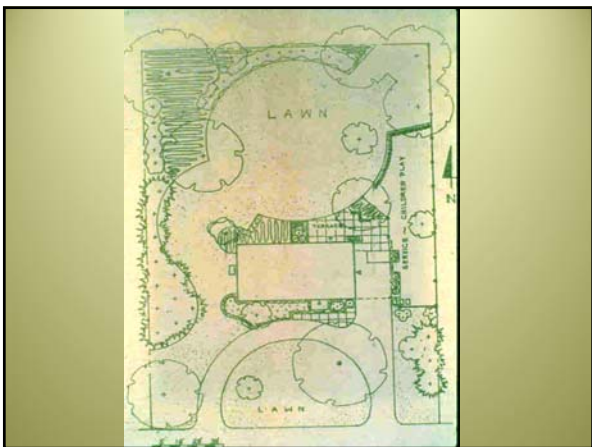

Accent

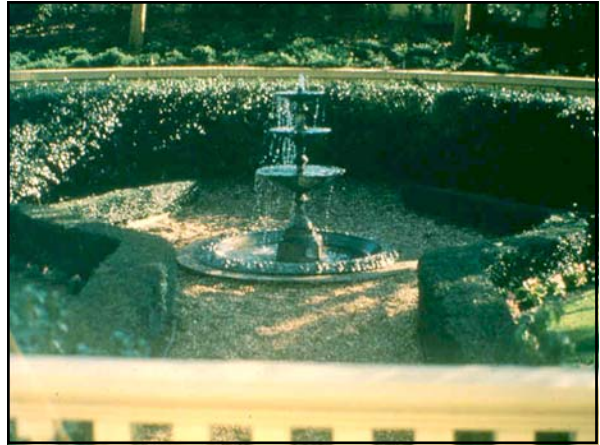
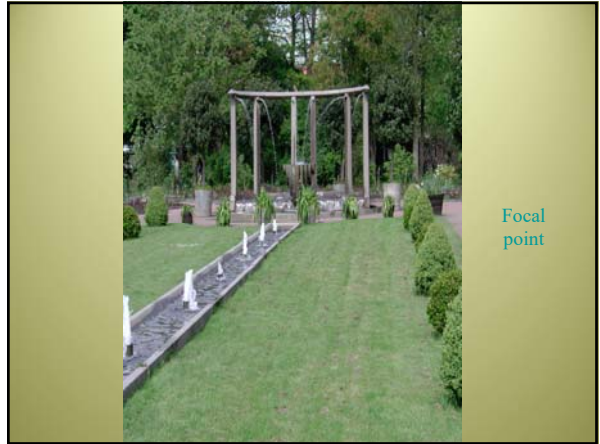

Cluster Plants

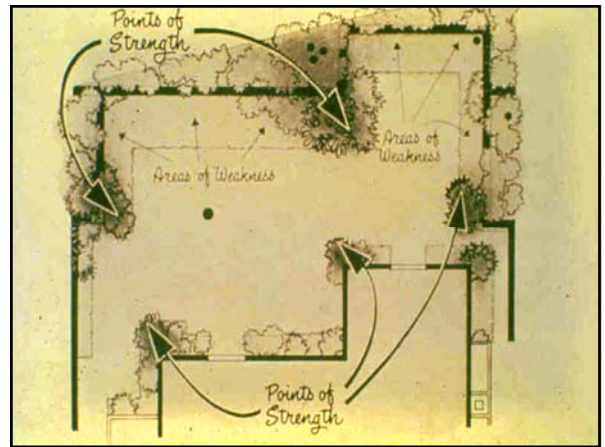
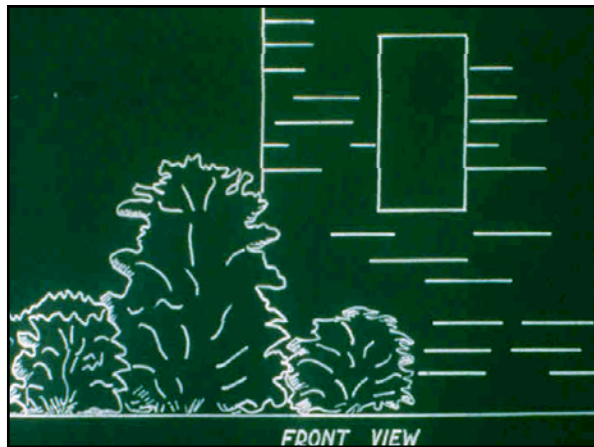
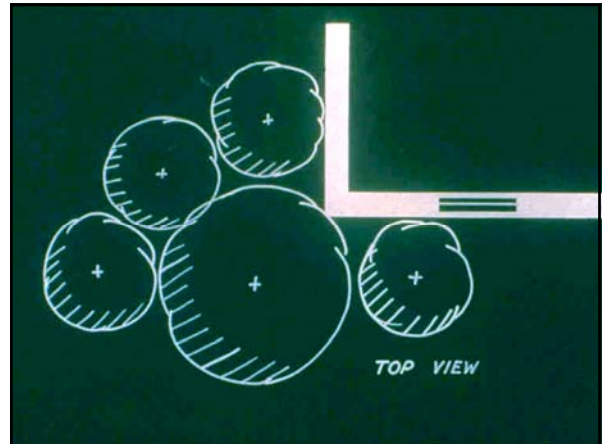

**Basic design using 3 to 5
different plants**

Use odd numbers

Curving bed lines

Softening 90° angles





**Height or Rate
of Growth**





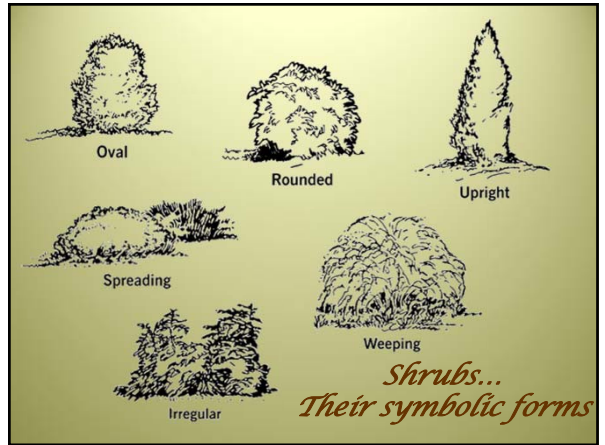







Mulches



Use of trees

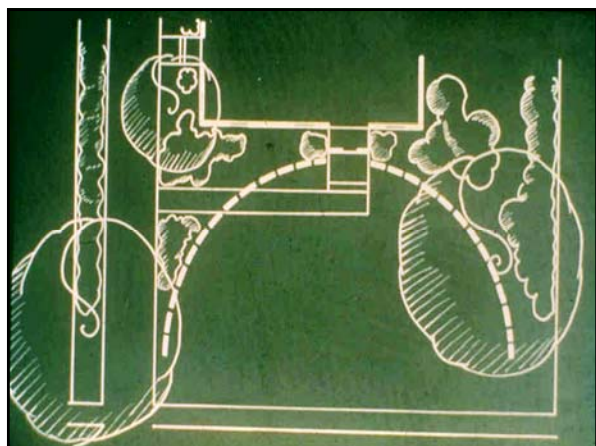
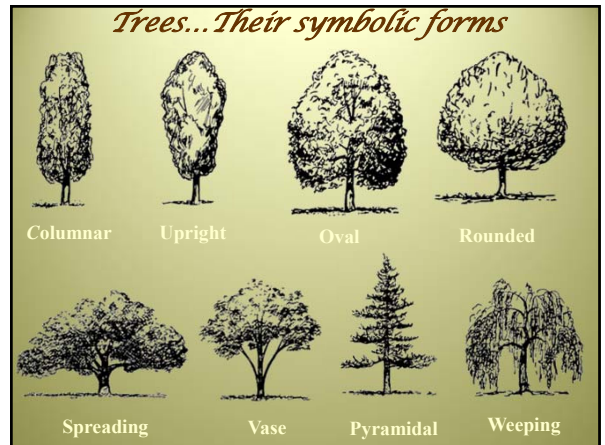









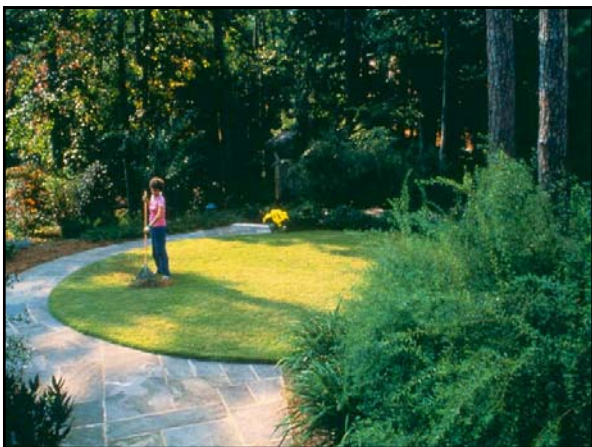

Average residential water use increases 30% - 50% during the summer months when citizens turn on their outdoor irrigation systems

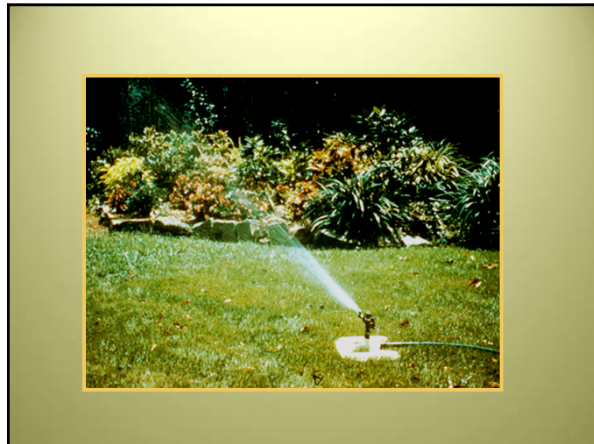

One portable lawn sprinkler operating 1 hour uses 360 gallons of water

This is equivalent to:
 14 five-minute showers
 26 runs of the dishwasher
 72 flushes of the toilet
 9 full loads of laundry

Seven Steps to a Water Wise Landscape

- ◆ Planning and Design
- ◆ Soil Analysis
- ◆ Appropriate Plant Selection
- ◆ Practical Turf Areas
- ◆ Efficient Irrigation
- ◆ Use of Mulches
- ◆ Appropriate Maintenance

Water Wise Landscape

- ◆ Planning and Design
 - Soil Analysis
 - Appropriate Plant Selection
 - Practical Turf Areas
 - Efficient Irrigation
 - Use of Mulches
 - Appropriate Maintenance

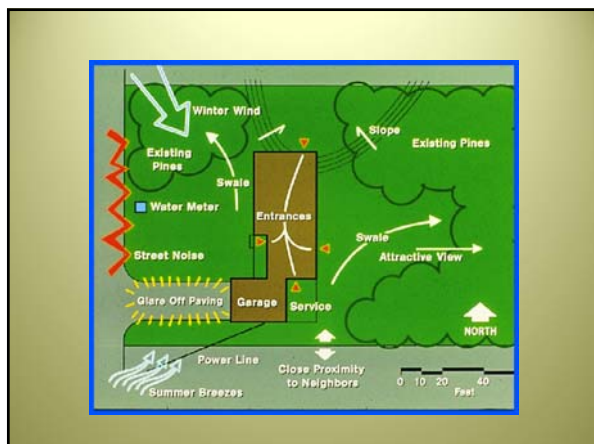

Divide the Landscape into Three Water-use Zones

- ◆ High Water-use Zone (Oasis Zone)
- ◆ Moderate Water-use Zone (Transition Zone)
- ◆ Low Water-use Zone (Xeric Zone)



OASIS LANDSCAPING

Key Area Transition Zone Open Area Transition Zone Edge Area

10% of the landscape is irrigated regularly
30% of the landscape is irrigated on demand
60% of the landscape is not irrigated

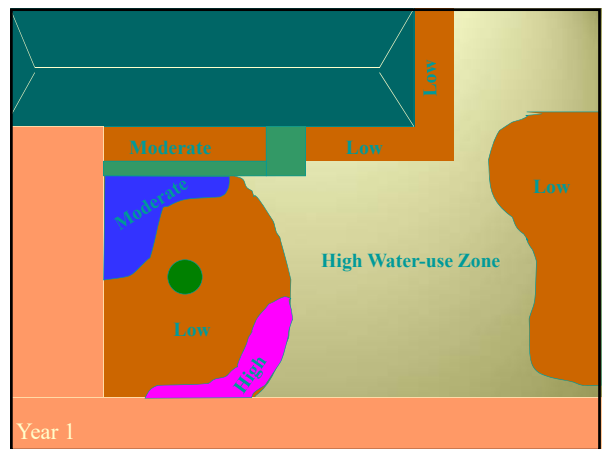
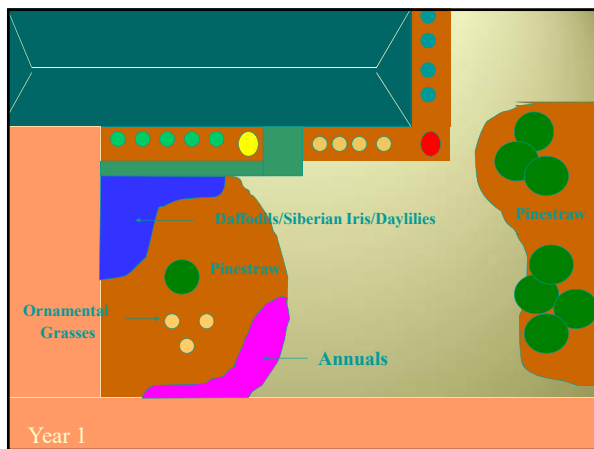
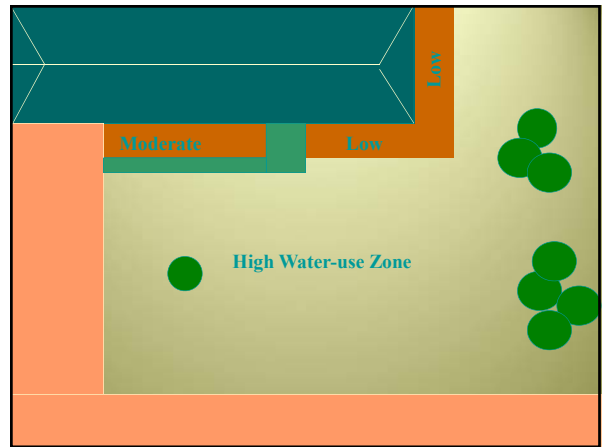
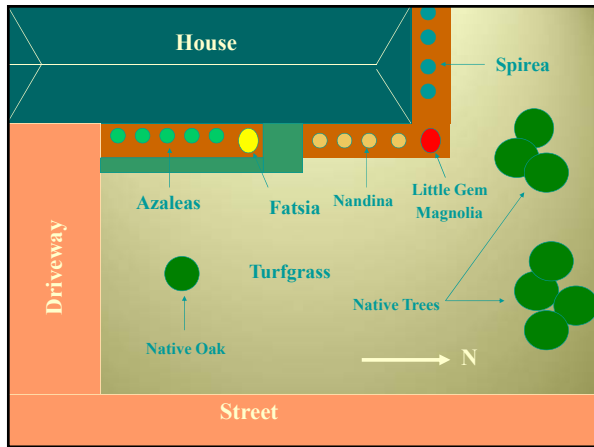

Water Wise Landscape

- ◆ Planning and Design
- ◆ Soil Analysis
- ◆ Appropriate Plant Selection
- ◆ Practical Turf Areas
- ◆ Efficient Irrigation
- ◆ Use of Mulches
- ◆ Appropriate Maintenance

Don't Guess...Soil Test!



Water Wise Landscape

- ◆ Planning and Design
- ◆ Soil Analysis
- ◆ Appropriate Plant Selection
- ◆ Practical Turf Areas
- ◆ Efficient Irrigation
- ◆ Use of Mulches
- ◆ Appropriate Maintenance

Select Plants Adapted to the Site and the Stresses of the Environment

Drought tolerance is important, but also consider potential insect and disease problems, sunlight and soil requirements.



Red-tip Photinia



Aralia

Hosta

Japanese Anemone

Shade



Liriope

Mondo grass

Sun



Water Wise Landscape

- Planning and Design
- Soil Analysis
- Appropriate Plant Selection
- Practical Turf Areas
- Efficient Irrigation
- Use of Mulches
- Appropriate Maintenance



Water Wise Landscape

- Planning and Design
- Soil Analysis
- Appropriate Plant Selection
- Practical Turf Areas
- Efficient Irrigation
- Use of Mulches
- Appropriate Maintenance

Adjust timers frequently according to changes in rainfall patterns

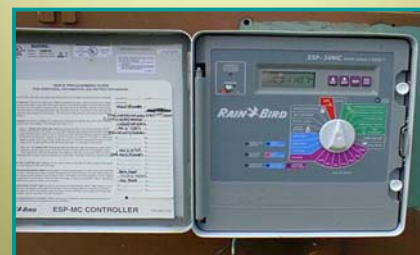

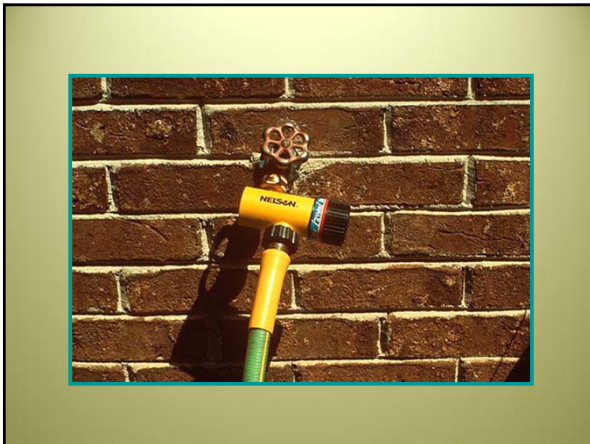

For most efficient use of water, irrigate between 9 pm and 9 am to avoid evaporative loss of water.

Avoid light, frequent irrigation because it encourages shallow rooting and increases water demand of the plant.

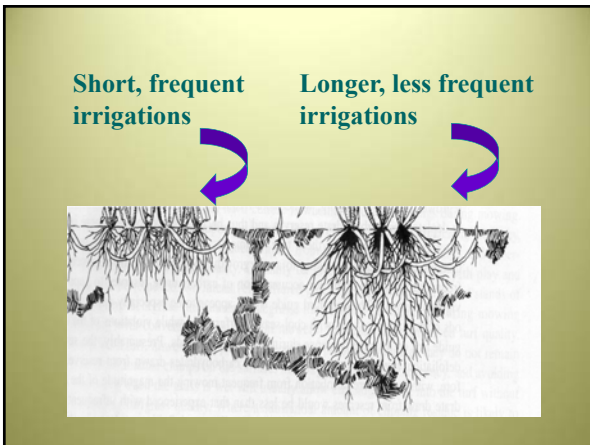

Water Wise Landscape

- ◆ Planning and Design
- ◆ Soil Analysis
- ◆ Appropriate Plant Selection
- ◆ Practical Turf Areas
- ◆ Efficient Irrigation
- ◆ Use of Mulches
- ◆ Appropriate Maintenance



Water Wise Landscape

- ◆ Planning and Design
- ◆ Soil Analysis
- ◆ Appropriate Plant Selection
- ◆ Practical Turf Areas
- ◆ Efficient Irrigation
- ◆ Use of Mulches
- ◆ Appropriate Maintenance

Avoid Frequent Flushes of Vegetative Growth Brought on by:

- ◆ Fertilization
- ◆ Pruning

Prune by selective thinning instead of shearing



Water Wise Landscape

- ◆ Planning and Design
- ◆ Soil Analysis
- ◆ Appropriate Plant Selection
- ◆ Practical Turf Areas
- ◆ Efficient Irrigation
- ◆ Use of Mulches
- ◆ Appropriate Maintenance



